

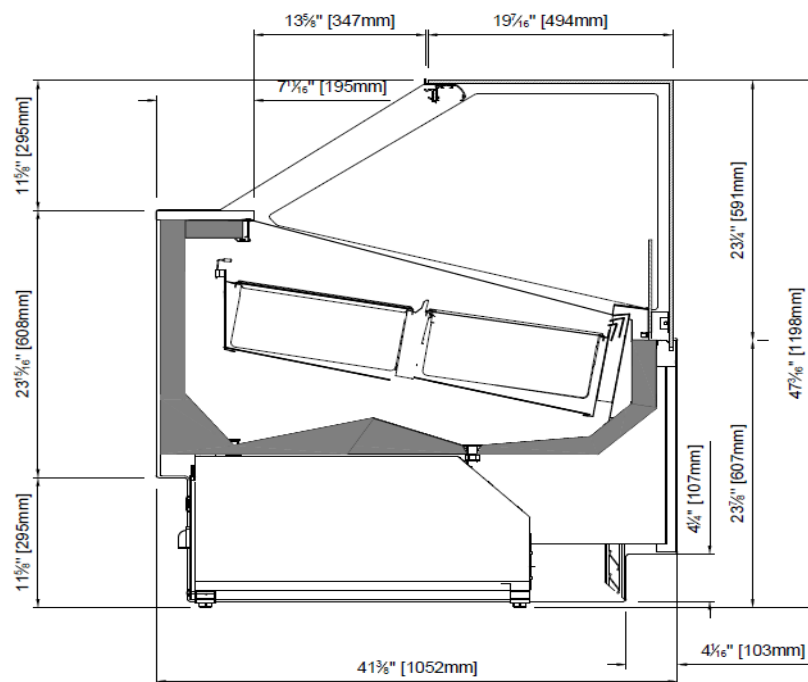

Model:

VCB_UH SERIES
FLAT GLASS GELATO



ESTANDAR FEATURES



EXTERIOR

- ⊗ Laminated sheet
- ⊗ Worktop in compac Quartz white.
- ⊗ Sides and decoration in water-resistant
- ⊗ Heated and liftable front glass.
- ⊗ Modulair line.
- ⊗ Double side glass



INTERIOR

- ⊗ AISI 304 Stainless Steel.
- ⊗ Low consumption LED lighting.
- ⊗ Rear night curtain
- ⊗ Anodized steel profiles
- ⊗ LED lighting in the upper profile, exposure plane and decoration.



INSULATION

- ⊗ CFC-Free polyurethane insulation, entire cabinet structure is foamed-in place using a high density polyurethane insulation.
- ⊗ Low GWP & Zero ODP effect.



ELECTRICAL AND ELECTRONIC CONTROLLERS

- ⊗ Remote alarm signals.
- ⊗ NTC temperature probes encapsulated and sealed.
- ⊗ Good visualization of the temperature
- ⊗ Cord and NEMA 6-20P plug. Electrical connections is 220V/ 1ph/ 60 Hz



REFRIGERATION

- ⊗ Digital temperature controller with automatic defrost system.
- ⊗ Ventilated condensation system.
- ⊗ Forced evaporation system
- ⊗ Stainless steel evaporative tray with electric heating element



OPTIONAL FEATURES

- ⊗ Tray combination (14 1/6 x 6 1/2 x 6)
- ⊗ Tray combination (14 1/6 x 9 5/6 x 3 1/7)

RECOMMENDED OPERATING CONDITIONS

- >>> Equipment has been designed to operate in an environment where temperature and humidity do not exceed 75°F (24°C) and 55% relative humidity.
- >>> Unit should not be installed near HVAC vents, fans or doorways that will disrupt the air curtain and compromise the function of the cabinet.
- >>> Unit should not be installed in direct sunlight.
- >>> Model will run most efficiently when completely loaded with pre-chilled product.
- >>> Condensing coils should be cleaned regularly to avoid equipment malfunction.
- >>> Please be advised that this type of models are louder than standad refrigeration models.
- >>> Unit cannot be encased in a way that would block appropriate airflow and cause the recycling of hot air.
- >>> A mimumum distance of 4-5 inches is required at the back and top of the unit, do nos flush the back of equipment directly to wall.
- >>> Do not block any vents with product or any other item.
- >>> Equipment must be loaded with pre-cooler product.
- >>> Do not overload the shelves and/or block in a way that would prevent proper airflow.
- >>> Maintain the acrylic ain diffuser at all times.

GENERAL DATA

	MODEL		
	VCB12UH+	VCB15UH+	VCB18UH+
	Low Temperature		
LENGTH (in)	49 1/5	61 1/2	73 5/6
SIDE PANEL THICKNESS (in)	4/5		
TOTAL VOLUME (Ft ³)	6 3/7	8	9 2/3
TDA - AREA TOTAL DISPLAY (Ft ²)	9 1/7	11 2/5	13 2/3
UNIT WEIGHT (lb)	560	699	763
CREATED DIMENSIONS (in)	55 5/7 x 47 5/7 x 61 1/2	68 1/9 x 47 5/7 x 61 1/2	80 1/3 x 47 5/7 x 61 1/2

INSTALLATION DETAILS

DATA TAB1

MODEL	1250	1562	1875
A (in)	16 1/7	16 1/7	16 1/7
B (in)	29 2/3	29 2/3	29 2/3
C (in)	10	10	10

FOOT | WHEELS POSITION

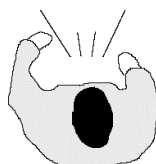
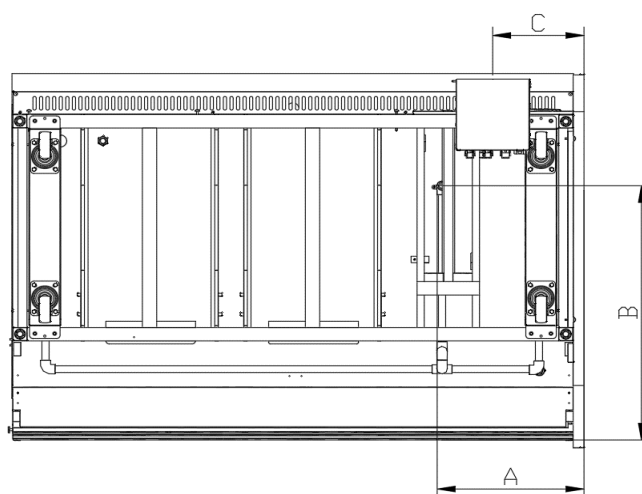

TECHNICAL CONFIGURATION

INTERIOR TEMPERATURE	SET POINT	LOW TEMPERATURE [5°F/-0°F]
	DIFFERENTIAL	-1°F 38°F
DEFROST TYPE	RESERVED CYCLE	
N° DEFROSTS / 24h	4	
END OF DEFROSTING TEMPERATURE	41°F	
MAXIMUM DEFROSTING TIME	15'	

In compliance with UL471 and NSF7

Ambient Temp.	Humidity
+75 °F	55 %

EVAPORATION	COLD DISH
CONDENSATION	VENTILATED
EVAPORATION WATER COLLECTION	-

VOLTAGE	220V/60Hz
SOUND LEVEL	≤70 dB

INSTALLATION DATA

BASE EQUIPMENT			MODEL						
			VCB12UH+		VCB15UH+		VCB18UH+		
COMPRESSOR		N°	1		2		2		
		V/Hz	220/60						
		Btu	2117		1867	2117	1867	2117	
		W	678		494	678	494	678	
		hp	1		1	1	1	1	
		A	3,52		3,7	3,52	3,7	3,52	
REFRIGERANT		Type	R290						
		lb	0,331		0,308	0,264	0,308	0,264	
COIL FANS		N°	2		3		5		
		V/Hz	220/60						
		W	4,8		4,8		4,8		
		A	0,07		0,07		0,07		
CONDENSATOR FANS		N°	2		2		2		
		V/Hz	220/60						
		W	25		25		25		
		A	0,425		0,425		0,425		
ANTI-FOG RESISTANCE		W	336		420		504		
		A	1,5		1,9		2,3		
LIGHTING LED		W	37,5		46,9		56,3		
		A	0,17		0,21		0,26		
POWER		W	1111		1703		1806		
TOTAL AMPERES		220V	A	6,21		10,40		18,11	
MCA			A	7,8		13,0		13,7	
MOP			A	10,6		15,0		15,6	
TOTAL CONSUMPTION		kWh/24h	18,7		28,6		30,3		