

Project: _____
 Location: _____
 Item #: _____ Quantity: _____
 Model #: _____

MODEL: IMD-SPC501/IMD-SPC501B BEER BOTTLE COOLER SUPERCOOLER



IMD-SPC501B

General Strengths

- ✓ **Sanitation.** Quick ability to take off shelves and slides for interior cleaning.
- ✓ **Doors.** All doors include door gaskets, easy to remove and snap in.
- ✓ **Control systems.** Higher precision in managing temperature settings. Greater ability for the adjustment of temperatures ranges as per the end user's requirement.
- ✓ **100% Tested.** All condenser units are tested 100%, in helium chambers for refrigerant leak detections.
- ✓ **Certified.** Audited and Certified by **INTERTEK** for compliance with UL 471 and NSF 7. EQA audited and certified by internationally recognized firm. ISO 9001:2015 (Quality); ISO 14001:2015 (Environmental); ISO 45001:2018 (Prevention and Worker Safety)
- ✓ **Lighting.** LED lighting in cabinet sides reduces the energy consumption by 80% and 90% compared to a traditional bulb. Provides a much better light quality.



Review:00 Date: 04/08/2024 IMD-SPC501/SPC501B

ETL LISTED TO UL471 STANDARD AND SANITATION CLASSIFIED TO NSF7 - WE RESERVE THE RIGHT TO CHANGE SPECIFICATIONS WITHOUT PRIOR NOTICE

MODEL: IMD-SPC501/IMD-SPC501B BEER BOTTLE COOLER SUPERCOOLER

STANDARD FEATURES

➤ **Exterior**

- Stainless Steel AISI 304 (IMD – SPC501).
- Black lacquered steel (IMD- SPC501B).
- Completely injected compact structure.
- Leveling feet.

➤ **Interior**

- Stainless Steel AISI 430 (IMD – SPC501).
- Stainless Steel AISI 430 (IMD – SPC501B).
- LED lighting.

➤ **Doors**

- Double pane glass door.
- Triple chamber snap in door seals for easy removal.
- Door lock.

➤ **Insulation**

- Polyurethane with high density 40kg/m³, CFSs free, zero ODP and low GWP.

➤ **Shelving**

- IMD-SPC501 / IMD-SPC501B:
5 Shelves, 22-3/64" x 18-57/64" (560X480mm)
- Guides and shelves easy to take off for cleaning.

➤ **Refrigeration**

- Digital temperature controller with automatic defrost system.
- Forced air evaporation system.
- Forced air condensation system.
- Evaporative pan.
- Evaporator coil coated with anti-corrosion material.
- **Refrigeration capacity:**
IMD-SPC501 - 2864 Btu/h (14°F) / 839W (-10°C)
IMD-SPC501B -2864 Btu/h (14°F) / 839W (-10°C)

OPTIONAL FEATURES

- ✓ Set of 2" Casters, front locking
- ✓ Electrical connection is 230 V / 1ph / 50Hz (plug type varies).
Models;
- IMD-SPC501_B: 4,09 A.
- ✓ Electrical connection is 230 V / 1ph / 60Hz (plug type varies).

➤ **Electrical**

- Cord and NEMA 5-15P plug,
- Electrical connection is 115 V / 1ph / 60 Hz.





Project: _____
 Location: _____
 Item #: _____ Quantity: _____
 Model #: _____

MODEL: IMD-SPC501/IMD-SPC501B BEER BOTTLE COOLER SUPERCOOLER

MODELS	Dimensions (inches) (mm)			Doors	Shelves	Ref.	Ref. Weight (Lbs.) (gr.)	Temperature Range (°F) (°C)	Cond. Unit	Capacity (Cu.Ft.) (L)	Case Amps 115V	Crated weight (Lbs.) (Kg.)
	W	D	H									
IMD-SPC501	27 (687)	27,6 (7012)	78,9 (2003)	1	5	R290	0,28 (130)	32°F/17,6°F (+0°C/-8°C)	3/4	17,65 (500)	8,31	300 136
IMD-SPC501B	27 (687)	27,6 (7012)	78,9 (2003)	1	5	R290	0,28 (130)	32°F/17,6°F (+0°C/-8°C)	3/4	17,65 (500)	8,31	300 136

ELEVATION

RIGHT VIEW

PLANT VIEW

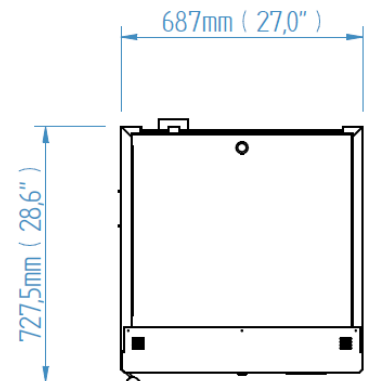
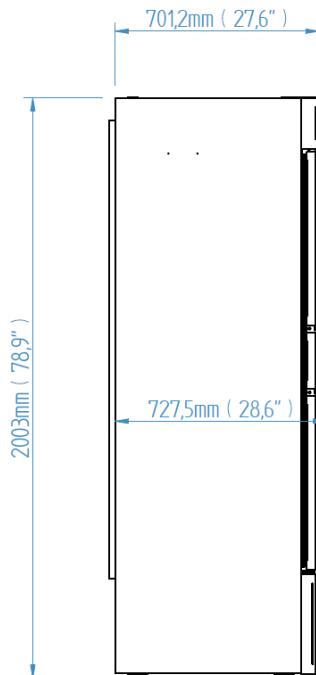
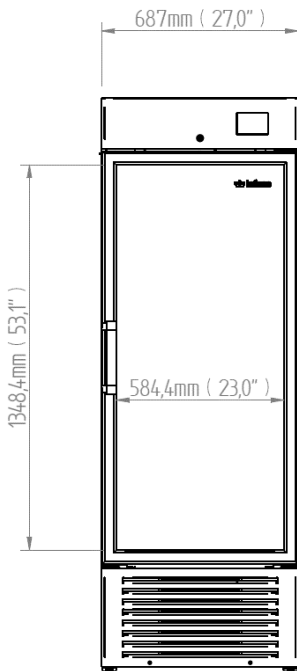

Review:00 Date: 04/08/2024 IMD-SP(01/SPC501B

ETL LISTED TO UL471 STANDARD AND SANITATION CLASSIFIED TO NSF7 – WE RESERVE THE RIGHT TO CHANGE SPECIFICATIONS WITHOUT PRIOR NOTICE



INFRICO-North America Corporate División
 11200NW 25th St ste 123, Sweetwater, FL, 33172
 (305) 777 9599

www.infrico.us
sales@infrico.com