

**MODEL: IUC-UC27FW / IUC-UC36FW
 IUC-UC48FW / IUC-UC60FW**

**UNDERCOUNTER:
 Shallow Depth Worktop Refrigerators**



GENERAL FEATURES

- ✓ **Higher energy efficiency.** R290 refrigerant with electric fans and evaporative tray without electric resistances.
- ✓ **Sanitation.** The interior cabinet is built for easy cleaning. Quick ability to take off shelves and slides for interior cleaning.
- ✓ **Doors.** Self-closing door system with permanent pressure. Stay open feature included when door remain open after 95 degrees. All doors include triple chamber door gaskets, easy to remove and shap in.
- ✓ **Control System.** Greater ability for the adjustment of temperature range as per the end user's requirements.
- ✓ **100% Tested.** All condensing units undergo rigorous testing in helium chambers for refrigerant leak detection and a final equipment test in a state-of-the-art test room.
- ✓ **Certified.** Audited and Certified by INTERTEK for compliance with UL 471 and NSF 7.



Review:01 Date: 01/23/2024 IUC-UC_FW

ETL LISTED TO UL471 STANDARD AND SANITATION CLASSIFIED TO NSF7 – WE RESERVE THE RIGHT TO CHANGE SPECIFICATIONS WITHOUT PRIOR NOTICE

**MODEL: IUC-UC27FW / IUC-UC36FW
 IUC-UC48FW / IUC-UC60FW**

**UNDERCOUNTER:
 Shallow Depth Worktop Refrigerators**

STANDARD FEATURES

➤ Exterior

- AISI 304 Stainless Steel Top.
- AISI 430 Stainless Steel.

➤ Interior

- AISI 430 Stainless Steel.

➤ Door

- Polyurethane insulated door.
- Self-closing door with stay open feature.
- Stainless Steel heavy-duty hinges.
- Triple chamber snap in door gaskets for easy removal and cleaning.
- Field reversible door (parts not included).
- Full-height door opening: 23-1/4" x 21-7/8" (650x 555 mm).

➤ Insulation

- CFC- Free polyurethane insulation, entire cabinet structure is foamed-in using a high-density polyurethane insulation.
- Low GWP & Zero ODP effect.

➤ Casters

- 2" Diameter casters already installed.
- Locks provided on front set.

➤ Shelving

- (2/4/4/4) Plastic coated wire shelves.
- Set of Stainless- Steel shelf brackets.
- Easy remove for cleaning.
- Dimensions WxD: 22-1/4" x 17" (GN2/1) (565x432 mm).

➤ Refrigeration

- Temperature regulated by thermostatic control.
- Temperature display.
- Energy-saving non-electric condensate pan.
- Evaporator coil coated with anti-corrosion material 100% polyester.
- Forced air refrigeration system.
- Electric fans.
- **Refrigeration capacity:**
 IUC-UC27FW - 1046 Btu/h(-22°F)/ 307 W(-30°C).
 IUC-UC36FW - 1046 Btu/h(-22°F)/ 307 W(-30°C).
 IUC-UC48FW - 1510 Btu/h(-22°F)/ 443 W(-30°C).
 IUC-UC60FW -1558 Btu/h (-22°F) / 457 W(-30°C).

➤ Electrical

- Cord and NEMA 5-P plug,
- Electrical connection is 115V / 1ph / 60 Hz.
- 15 AMP breakers required.



OPTIONAL FEATURES

- ✓ Electrical connection is 230 V / 1 ph / 50 Hz (Plug type varies).
- ✓ Single overshelf kit.
- ✓ Double overshelf kit.
- ✓ 4" backsplash.
- ✓ Set of 2" diameter casters, with lock provided on front set.

➤ ETL Listed to UL471 Standard and Sanitation classified to NSF7.

**MODEL: IUC-UC27FW / IUC-UC36FW
 IUC-UC48FW / IUC-UC60FW**

**UNDERCOUNTER:
 Shallow Depth Worktop Refrigerators**

Model	Dimensions (inches) (mm)			Doors	Shelves	Ref.	Ref.Weight (Lbs.) (gr.)	Temperature Range (°F) (°C)	Cond. Unit (H.P)	Capacity (Cu.Ft.) (L)	Case Amps 115V	Net weight (Lbs.) (Kg.)
	W	D	H									
IUC-UC27FW	27-7/8 (707)	30-3/4 (782)	39-5/8 (1007)	1	2	R290	0,19 (90)	0 °F (-18°C)	1/2	8 (226)	3,38	270 (122)
IUC-UC36FW	36-3/8 (924)	30-3/4 (782)	39-5/8 (1007)	2	4	R290	0,22 (100)	0 °F (-18°C)	1/2	11 (311)	3,44	319 (145)
IUC-UC48FW	48-3/8 (1229)	30-3/4 (782)	39-5/8 (1007)	2	4	R290	0,22 (100)	0 °F (-18°C)	1/2	14 (396)	3,44	354 (160)
IUC-UC60FW	60-1/2 (1537)	30-3/4 (782)	39-5/8 (1007)	2	4	R290	0,24 (110)	0 °F (-18°C)	1/2	17 (481)	5,33	430 (195)

PLAN VIEW

ELEVATION

PLAN VIEW

RIGHT VIEW

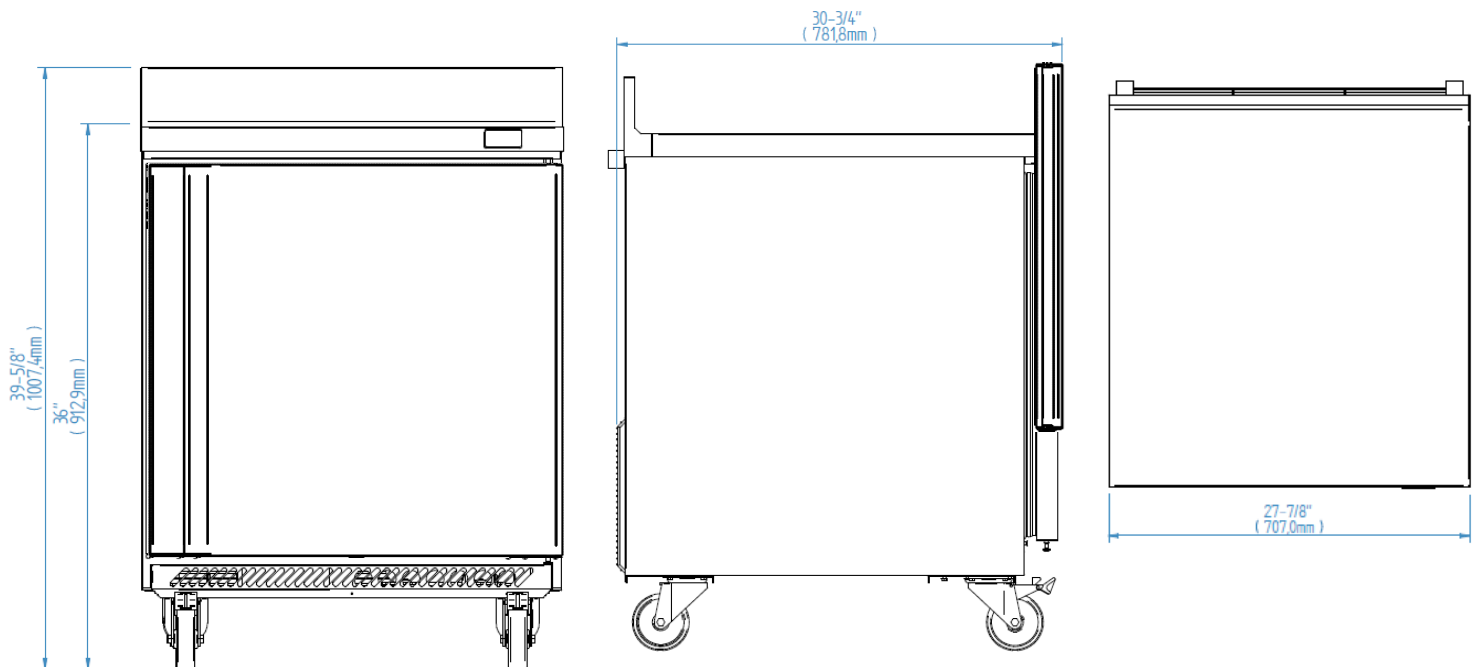

IUC-UC27FW

Review:01 Date: 01/23/2024 IUC-UC FW
 ETL LISTED TO UL471 STANDARD AND SANITATION CLASSIFIED TO NSF7 – WE RESERVE THE RIGHT TO CHANGE SPECIFICATIONS WITHOUT PRIOR NOTICE

**MODEL: IUC-UC27FW / IUC-UC36FW
 IUC-UC48FW / IUC-UC60FW**

**UNDERCOUNTER:
 Shallow Depth Worktop Refrigerators**

ELEVATION

PLANT VIEW

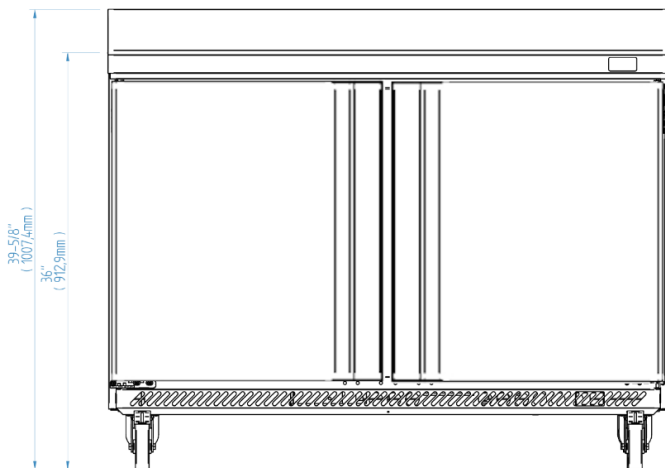

IUC-UC36FW

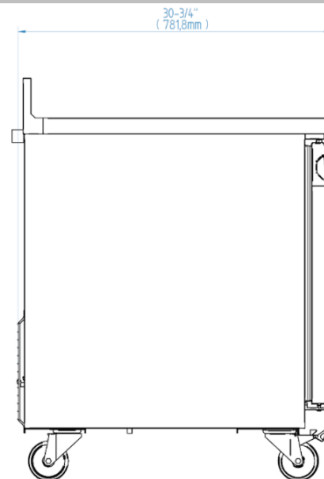

RIGHT VIEW

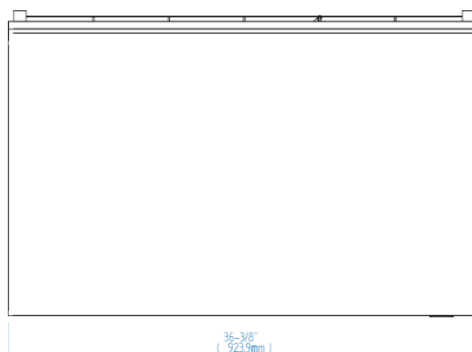

ELEVATION

PLANT VIEW

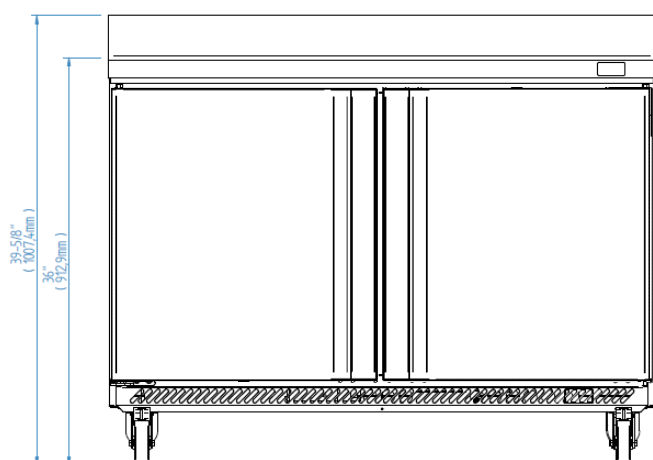

IUC-UC48FW

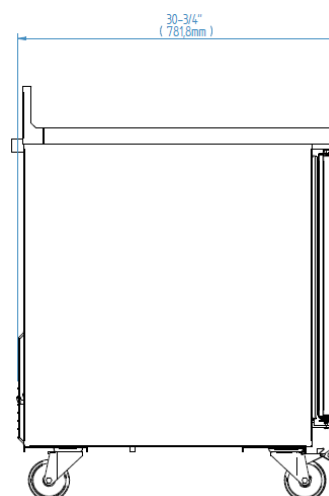

ETL LISTED TO UL471 STANDARD AND SANITATION CLASSIFIED TO NSF7 – WE RESERVE THE RIGHT TO CHANGE SPECIFICATIONS WITHOUT PRIOR NOTICE

**MODEL: IUC-UC27FW / IUC-UC36FW
 IUC-UC48FW / IUC-UC60FW**

**UNDERCOUNTER:
 Shallow Depth Worktop Refrigerators**

RIGHT VIEW

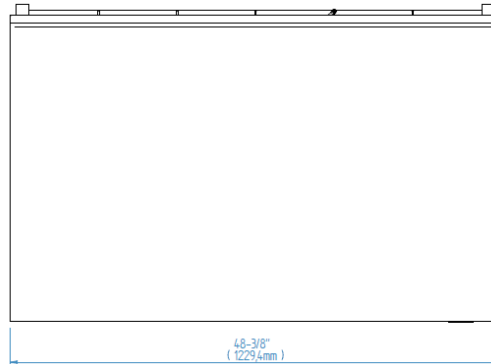

ELEVATION

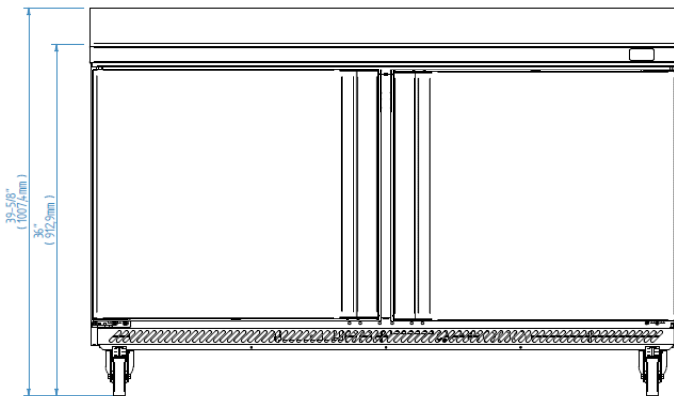

PLANT VIEW

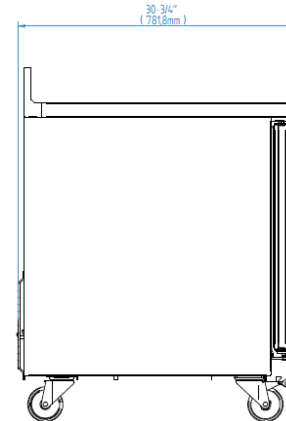

IUC-UC60FW

RIGHT VIEW

