

TO OPERATE:

1. Place strainer screens and scrap basket into position in the prep washer tank.

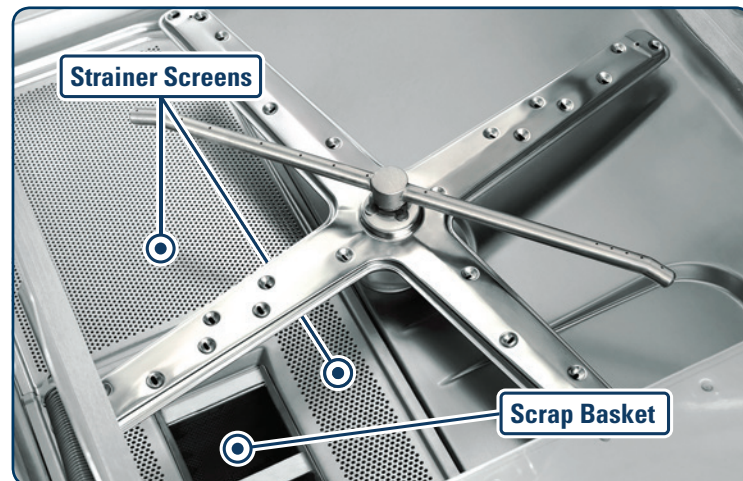

2. Close machine door and push the **"POWER"** button. The word **"FILL"** will be displayed.

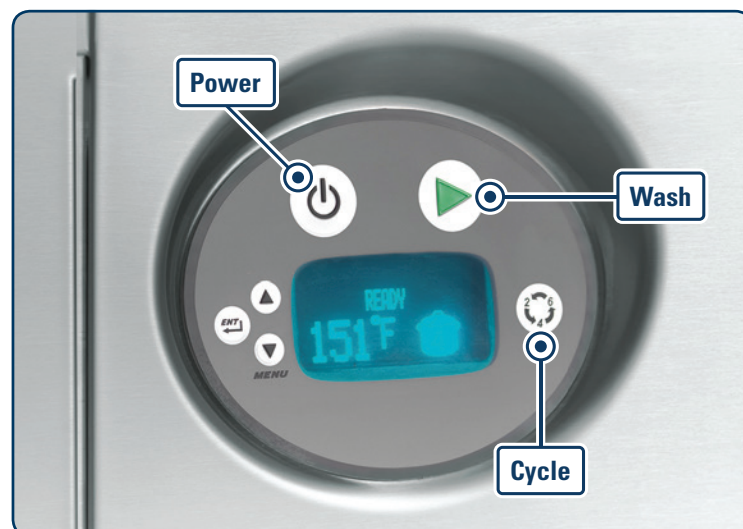

3. When fill is complete, the readout will display **"READY"** and the wash water temperature.
 - ❶ **Select the wash cycle:** 2, 4 or 6 (toggle through cycle options by pressing the **"CYCLE"** button).
 - ❷ Open door, pull out rack and load. Slide rack back into machine.

4. Close the door. Press the **"WASH"** button (green arrow). For Advansys™ models the door will lock and a cycle light will be displayed for the complete cycle.

NOTE: Each wash cycle is followed by an automatic rinse. Throughout the wash portion of the cycle, the wash water temperature is displayed, along with the word **WASH** and an icon. During the rinse cycle, the rinse water temperature will be displayed, along with the word **RINSE** and an icon. For Advansys™ models, the rinse cycle will be followed by a 99-190 second **CONDENSING CYCLE**.

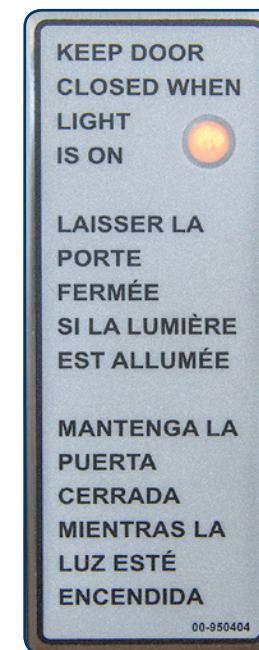

5. Do not open the door until display shows **"READY"** and sump temperature is displayed. For Advansys™ models: the cycle light will turn off, the door will unlock and the display will show **"READY"** along with the sump temperature.

OPERATIONAL TIPS:

- Pre-scrap to remove large food particles and debris.
- Do not stack pots, pans, bowls, etc. on top of another.
- Use only commercial detergents and chemicals with Prep Washer.
- The dishwasher should be delimed on a regular basis as required. Consult a chemical professional for deliming chemicals. All Prep washers are equipped with an automatic delime cycle reminder. It is recommended that deliming be done when **DELIME RECOMMENDED** is lit. PW10eR and PW20eR models are equipped with an internal delime pump which will automatically pump the required amount of deliming agent into the unit.

TO CLEAN:

1. Spray down the inside of the machine with spray wand.
2. Close machine door. Push the **"POWER"** button.
 - The machine will drain and shut down.
3. Open the machine door.
4. Remove rack, strainer screens and scrap basket and rinse thoroughly.
5. Make sure the upper and lower wash and rinse arms rotate freely and are clear of any obstructions. If not, remove arms and clean out obstructions.
6. Spray down the sump with spray wand.
7. Re-assemble the machine.
 - ❶ Replace scrap screen and scrap basket.
 - ❷ Install wash and rinse arms if removed
 - ❸ Replace rack
8. Turn machine back on for 2 minutes to fill.
9. Turn off machine again to flush sump.
10. Wipe down machine interior and exterior with a clean, damp cloth. **DO NOT USE STEEL WOOL, A SCOURING PAD OR ABRASIVE MATERIAL TO CLEAN THE MACHINE.**
11. On Advansys™ machines, every 6-12 months, remove and clean baffles (above the upper wash and rinse arms).

NOTE: For end of the day cleaning, complete steps 1-10 and leave the door open to allow the interior to air out and dry.

Refer to the PW Installation Manual or Operator Training Video or call your local Hobart Sales/Service office if you experience any difficulties.