



**"WE MAKE THE KITCHEN BETTER!"**

**ATOSA USA, INC.**

**Toll Free: 855-855-0399 Email: [info@atosausa.com](mailto:info@atosausa.com)**

**[www.atosa.com](http://www.atosa.com) | [www.atosausa.com](http://www.atosausa.com)**

**California, Colorado, Florida, Georgia, Illinois,  
New Jersey, Ohio, Texas, Washington**

# Countertop Refrigerated Display Case

## MODELS:

DSRC-28

## Standard Features

- 4-sided glass display case with glass door
- Black exterior trim with stainless steel base
- Digital temperature controller and display
- 3 shelves standard
- Leveling legs



**DSRC-28**

For the best results of food preservation we recommend  
setting your refrigerator between 35 °F to 38 °F

1. Don't forget to leave the unit some room to breathe!
2. Please clean the condenser frequently to give the unit more fresh air.



**2 YEAR PARTS AND LABOR WARRANTY  
5 YEAR COMPRESSOR PART WARRANTY**





**"WE MAKE THE KITCHEN BETTER!"**

**ATOSA USA, INC.**

**Toll Free: 855-855-0399 Email: [info@atosausa.com](mailto:info@atosausa.com)**

[www.atosa.com](http://www.atosa.com) | [www.atosausa.com](http://www.atosausa.com)

California, Colorado, Florida, Georgia, Illinois,

New Jersey, Ohio, Texas, Washington

## SPECIFICATIONS

Models	Door	Capacity (Cu.Ft.)	Shelves	Rated Current (A)	Voltage (V/Hz/Ph)	HP	Refrigerant	Exterior Dimensions (inch)	Shelf Dimensions (inch)	Net Weight (lb)	Gross Weight (lb)
DSRC-28	1	2.8	3	2.2	115/60/1	1/7	R290	17 <sup>3/8</sup> ×15 <sup>3/4</sup> ×39 <sup>1/8</sup>	13 <sup>3/5</sup> ×12	97	111

## PLAN VIEW

**DSRC-28**

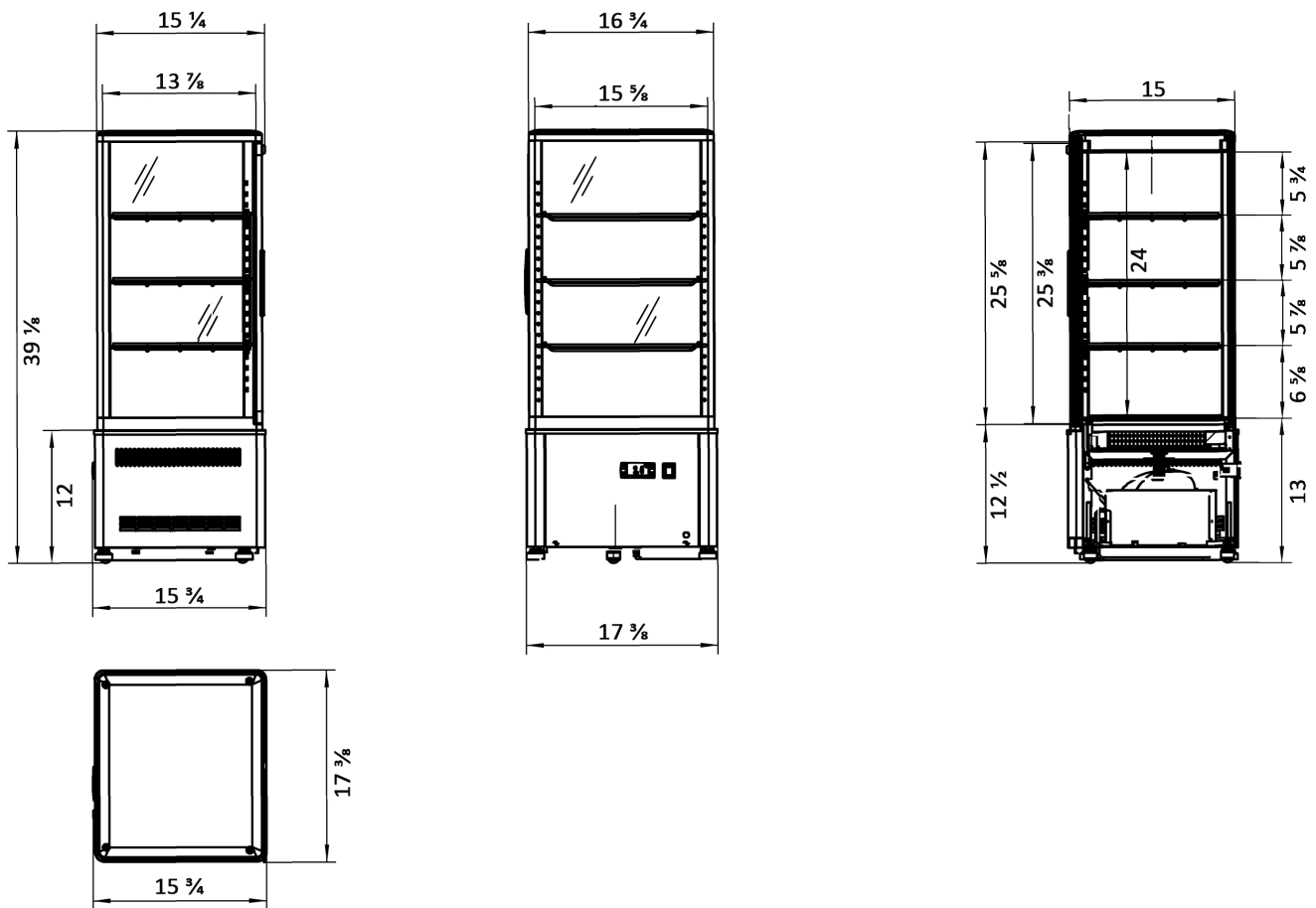

Door lock

LED lights

